

Science: States of matter

- ◆ Particles in a solid are close together and cannot move. They can only vibrate.
- ◆ Particles in a liquid are close together but can move around each other easily.
- ◆ Particles in a gas are spread out and can move around very quickly in all directions.
- ◆ If a solid is heated to its melting point, the particles move faster and it changes to a liquid.
- ◆ When freezing occurs, the particles in the liquid begin to slow down and they can only then move gently on the spot, giving them a solid structure.

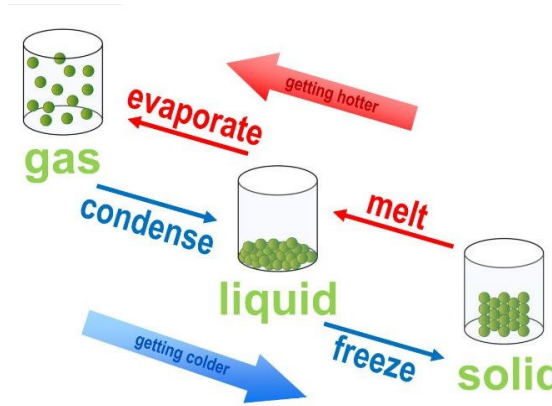
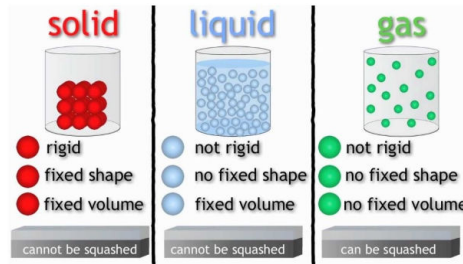

Vocabulary

- |              |               |
|--------------|---------------|
| state        | condensation  |
| solid        | water cycle   |
| liquid       | melting       |
| gases        | precipitation |
| freezing     | particle      |
| heating      | vibrate       |
| water vapour |               |
| evaporation  |               |

History: Historical potion use

- ◆ Potions are liquids that are said to have healing or magical properties.
- ◆ Before people knew about modern medicines, healing potions were thought to cure a range of health problems.
- ◆ Anaesthetics are medicines that put people to sleep when they have an operation so they do not feel pain during the surgery.



Medicine through Time Significant Individual Fact Cards

Elizabeth Garrett-Anderson  
1865  
The first female doctor in Great Britain.



Vocabulary

- |             |            |
|-------------|------------|
| potion      | doctor     |
| medicine    | surgeon    |
| anaesthetic | surgery    |
| herbal      | treatment  |
| health      | operation  |
| magic       | substance  |
| illness     | sedate     |
| pharmacy    | painkiller |

## Art: Observational drawing

- ◆ Observational drawing is when an artist observes an object, landscape or person and recreates it using a drawing in the most realistic way possible.
- ◆ Texture refers to the feel, appearance or consistency of a surface or a substance.
- ◆ Shading can be used to mark areas of light and dark.

## Shading techniques



## Vocabulary

texture	hatching
shading	scumbling
technique	stippling
drawing	cross-hatching
sketch	blending

## DT: Sculpting clay

- ◆ Clay is a soft substance used for sculpting.
- ◆ You can join pieces of clay together by pushing it together or using some slip, which is a mixture of clay and water that is used like glue.
- ◆ Sometimes clay is fired in a kiln to make it harder and more durable.
- ◆ Air-dried clay does not need to be fired in a kiln— you can

## Clay Techniques to Try

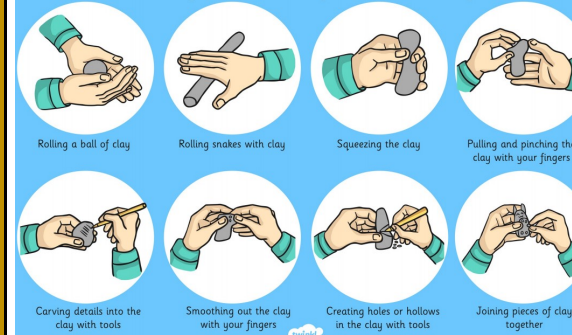

## Vocabulary

clay	pinch pot
sculpt	kiln
slip	carve
join	pottery
mould	
coil	

Information about states of matter



The history of anaesthetic



Practise different shading techniques



Clay building techniques

